

ERIS
SCALE 1" = 200'

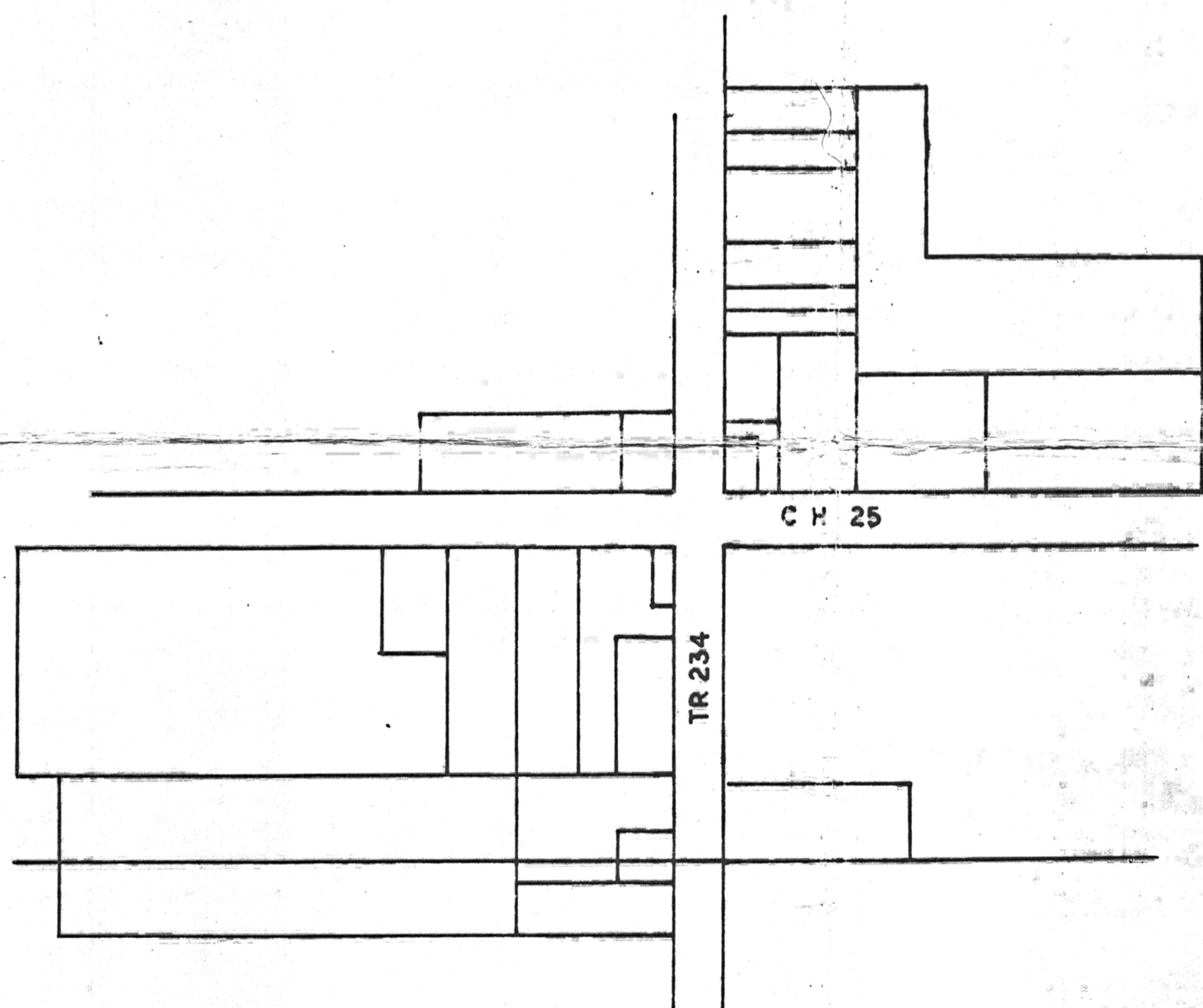

U 1 RURAL DISTRICT
R 1 LOW DENSITY RESIDENTIAL DISTRICT

THIS IS TO CERTIFY THAT THIS IS THE OFFICIAL ZONING MAP REFERRED TO IN ARTICLE VII OF THE ZONING RESOLUTION OF THE TOWNSHIP OF CONCORD, CHAMPAIGN COUNTY, OHIO.

Robert R. Russell
CHAIRMAN, BOARD OF TOWNSHIP TRUSTEES

William H. Allen
CLERK, BOARD OF TOWNSHIP TRUSTEES

July 1, 1980
DATE ADOPTED

CONCORD TOWNSHIP

FILED
At 2:45 P.M. Clerk P.M.
DEC 3 1991
CAROLYN J. DOWNING
Recorder, Champaign Co., Ohio

CHAMPAIGN COUNTY, OHIO
LOGAN-UNION-CHAMPAIGN REGIONAL PLANNING COMMISSION

DEVELOPMENT DEPARTMENT
PLANNING DIVISION
STATE OF OHIO

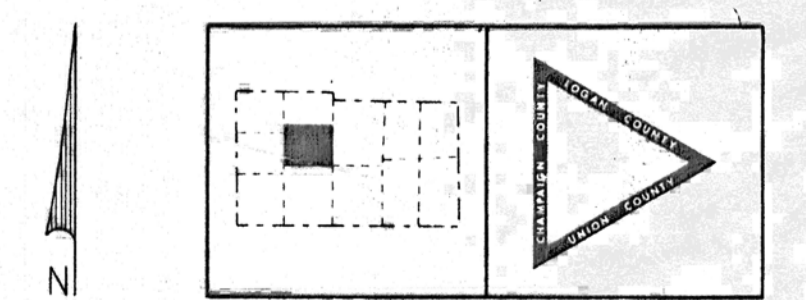
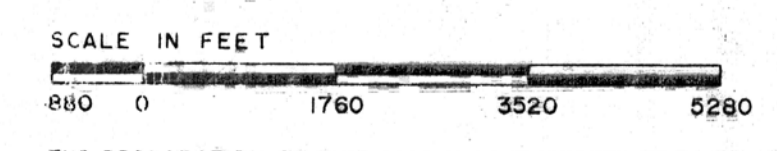

THE PREPARATION OF THIS MAP WAS FINANCED IN PART THROUGH AN URBAN PLANNING GRANT FROM THE DEPARTMENT OF HOUSING AND URBAN DEVELOPMENT, UNDER THE PROVISIONS OF SECTION 701 OF THE HOUSING ACT OF 1954, AS AMENDED.